



LOGAN REGIONAL HOSPITAL

500 East 1400 North
Logan, UT 84341

loganregional.org

HOSPITAL SERVICES DIRECTORY MEDICAL STAFF PHYSICIANS DIRECTORY (pages 2-5)

Hospital campus map on back

For numbers not listed below and patient information, call	435.716.1000
Administration	435.716.5450
Admitting	435.716.5379
Admitting (Surgery Only).....	435.716.5303
Behavioral Health Unit	435.716.5320
Billing (Patient Account Services/Business Office).....	435.716.5366
Cancer Center	1281 North 600 East, Logan, UT 84341
Communications (Public Relations).....	435.716.6400
Credit Union	435.716.5378
Dialysis.....	435.716.5392
Dialysis.....	435.716.2918
Education Center	435.716.5310
Eligibility Counseling	435.716.5367
Emergency.....	435.716.2240
GI Lab.....	435.716.5900
Gift Shop (Hospital).....	435.716.5482
Gift Shop (Women's Center)	435.716.6166
Hearing (Audiology) and Speech Services	435.716.5325
Heart Services (Cardiology).....	435.716.5305
Homecare (Home Health, Hospice).....	550 East 1400 North, Suite G, Logan, UT 84341
Homecare Medical Equipment	1300 North 200 East, Suite 106, Logan, UT 84341
Human Resources	435.716.5396
Imaging (Radiology, X-ray, Mammography, Ultrasound, CT Scan, MRI, Nuclear Medicine).....	435.716.5321
Infusion Center.....	435.716.5307
Intensive Care Unit/Cardiac Care Unit (ICCU).....	435.716.5418
Labor and Delivery	435.716.5400
Laboratory	435.716.5520
Lactation (Breast Feeding) Supplies Store.....	435.716.5401
Language Services.....	435.716.2560
Library	435.716.2166
Logan Regional Hospital Foundation	435.716.5315
Mammography.....	435.716.5415
Medical Records.....	435.716.5307
Medical Unit	435.716.5330
Mother/Baby Unit (Women and Newborn Center).....	435.716.5490
Newborn Intensive Care Unit	435.716.5376
Nutrition and Weight Management	435.716.5502
Operating Room	435.716.5329
Pediatric Rehabilitation.....	435.716.5438
Pediatrics Unit.....	550 East 1400 North, Suite W, Logan, UT 84341
Pharmacy (Intermountain Pharmacy in the Budge Clinic)	435.716.6440
Physical Therapy.....	435.716.5350
Purchasing/Materials Management	435.792.1521
Respiratory Care/Pulmonary Lab.....	435.716.2880
Senior Services.....	435.716.5180
Sleep Lab	435.716.5386
Social Work Services	435.716.5394
Spine Institute — Physical and Occupational Therapy	435.716.5709
Sports Medicine/Athletic Republic/Outpatient Rehabilitation.....	435.716.5398
Surgical Care Unit.....	435.716.5325
Surgical Center	435.716.2880
Transitional Care and Physical Rehabilitation Unit	435.716.5440
Voice TDD-TTY.....	435.716.5303
Volunteer Services.....	435.716.5444
	435.716.5373
	435.716.5324

MEDICAL STAFF PHYSICIANS DIRECTORY BEGINS ON NEXT PAGE

MEDICAL STAFF PHYSICIANS AT LOGAN REGIONAL HOSPITAL**ANESTHESIOLOGY**

Darren V. Anderson, MD	500 East 1400 North, Logan, UT 84341	435.753.1600
Michael L. Broadbent, DO	500 East 1400 North, Logan, UT 84341	435.753.1600
Matt A. Clissold, MD	500 East 1400 North, Logan, UT 84341	435.753.1600
Peter C. Daines, MD	500 East 1400 North, Logan, UT 84341	435.753.1600
Jodi F. Dayton, MD	500 East 1400 North, Logan, UT 84341	435.753.1600
Shane T. Gonzales, MD	500 East 1400 North, Logan, UT 84341	435.753.1600
Shane R. Larson, MD	500 East 1400 North, Logan, UT 84341	435.753.1600
Wesley S. Mortensen, MD	500 East 1400 North, Logan, UT 84341	435.753.1600
Brian D. Nelson, MD	500 East 1400 North, Logan, UT 84341	435.753.1600
Richard B. Palfreyman, MD	500 East 1400 North, Logan, UT 84341	435.753.1600
Frank E. Peterson, MD	500 East 1400 North, Logan, UT 84341	435.753.1600
Joel C. Robinson, MD	500 East 1400 North, Logan, UT 84341	435.753.1600
Jon R. Robison, MD	500 East 1400 North, Logan, UT 84341	435.753.1600
Courtney R. Skabelund, MD	500 East 1400 North, Logan, UT 84341	435.753.1600
David E. Skabelund, MD	500 East 1400 North, Logan, UT 84341	435.753.1600
Jefri A. Williams, DO	500 East 1400 North, Logan, UT 84341	435.753.1600

CARDIOLOGY

William L. Saul, MD	1300 North 500 East, Suite 320, Logan, UT 84341	435.755.8200
Rudolph Otrusnik, MD	1300 North 500 East, Suite 320, Logan, UT 84341	435.755.8200

DERMATOLOGY

Nathan W. Hanson, MD	1350 North 500 East, Logan, UT 84341	435.792.1770
Kelly W. Hubbard, MD	2380 North 400 East, Suite B, North Logan, UT 84341	435.752.5741
Bradley K. Summers, MD	550 East 1400 North, Suite R, Logan, UT 84341	435.755.9484
Robert P. Young, MD	550 East 1400 North, Suite Q, Logan, UT 84341	435.787.0560

EMERGENCY MEDICINE

William B. Evans, MD	500 East 1400 North, Logan, UT 84341	435.716.5446
Matthew F. Harris, MD	500 East 1400 North, Logan, UT 84341	435.716.5446
Douglas P. Plowman, MD	500 East 1400 North, Logan, UT 84341	435.716.5446
Brett C. Porter, MD	500 East 1400 North, Logan, UT 84341	435.716.5446
Trent Rasmussen, MD	500 East 1400 North, Logan, UT 84341	435.716.5446
David A. Reese, MD	500 East 1400 North, Logan, UT 84341	435.716.5446
Danny E. Spencer, DO	500 East 1400 North, Logan, UT 84341	435.716.5446
Ryan J. Stolworthy, MD	500 East 1400 North, Logan, UT 84341	435.716.5446
Chris L. Stegelmeier, MD	500 East 1400 North, Logan, UT 84341	435.716.5446
Nathan D. Whitaker, MD	500 East 1400 North, Logan, UT 84341	435.716.5446
NURSE PRACTITIONERS/PHYSICIAN ASSISTANTS:		
Jeffrey S. Adams, PA	500 East 1400 North, Logan, UT 84341	435.716.5446
Lindee Allen, APRN	500 East 1400 North, Logan, UT 84341	435.716.5446
Jeffrey G. Baugh, PA	500 East 1400 North, Logan, UT 84341	435.716.5446
Devon Dahlke, PA	500 East 1400 North, Logan, UT 84341	435.716.5446
Marc Lawson, PA	500 East 1400 North, Logan, UT 84321	435.716.5446
Sarah J. Parker, APRN	500 East 1400 North, Logan, UT 84341	435.716.5446

FAMILY MEDICINE

D. Barton Avery, MD	502 South Main, Smithfield, UT 84335	435.563.3222
Lars Bergeson, MD	456 West 280 North, Providence, UT 84332	435.752.0330
Jeremy W. Broadhurst, DO	190 South Hwy 165, Providence, UT 84332	435.755.3300
Todd A. Brown, MD	291 South Main, Suite C, Smithfield, UT 84335	435.563.6211
Nathan H. Call, MD	190 South Hwy 165, Providence, UT 84332	435.755.3300
Brian W. Carlson, MD	412 North 200 East, Logan, UT 84321	435.713.2800
Vera B. Carlson, MD	169 North Spring Creek Parkway, Suite 170, Providence UT 84332	435.752.5553
Thomas H. Clark, MD	412 North 200 East, Logan, UT 84321	435.713.2800
Kevin R. Duke, DO	456 West 280 North, Providence, UT 84332	435.752.0330
R. Mark Firth, MD	190 South Hwy 165, Providence, UT 84332	435.755.3300
Brad M. Goates, MD	412 North 200 East, Logan, UT 84321	435.713.2800
Gary L. Harris, MD	502 South Main, Smithfield, UT 84335	435.563.3222
Douglas R. Hyldahl, MD	412 East 200 North, Logan, UT 84321	435.713.2800
Corey B. Johnson, MD	1219 North 400 East, Logan, UT 84341	435.753.2842
Bruce A. Isaacson, MD	550 East 1400 North, Suite Z, Logan, UT 84341	435.755.5799
Richard T. Stevens, MD	456 West 280 North, Providence, UT 84332	435.752.0330
Matthew J. Welter, MD	2380 North 400 East, Suite A, North Logan, UT 84341	435.713.1300

GASTROENTEROLOGY

V. Duane Bohman, MD	630 East 1400 North, Suite 100A, Logan, UT 84341	435.787.0270
Dirk R. Davis, MD	630 East 1400 North, Suite 100A, Logan, UT 84341	435.787.0270
Vikram Garg, MD	1300 North 500 East, Suite 340, Logan, UT 84341	435.716.5900
Bryan R. Larsen, MD	630 East 1400 North, Suite 100A, Logan, UT 84341	435.787.0270

GENERAL SURGERY

Allan D. Anderson, MD	1350 North 500 East, Logan, UT 84341	435.792.1950
Scott W. Grover, DO	550 East 1400 North, Suite D, Logan, UT 84341	435.752.7122
Mark T. Hansen, MD	2380 North 400 East, Suite G, North Logan, UT 84341	435.713.1390
David L. Harker, MD	1350 North 500 East, Logan, UT 84341	435.792.1950
Kevin A. Murphy	440 West 600 North, Tremonton, UT 84337	435.257.7441
Bartley M. Weiss, MD	1350 North 500 East, Logan, UT 84341	435.792.1950

HOSPITALIST

Karl L. Brown, MD	500 East 1400 North, Logan, UT 84341	435.716.1000
Robert B. Duncan, DO	500 East 1400 North, Logan, UT 84341	435.716.1000
Rob K. Perkins, MD	500 East 1400 North, Logan, UT 84341	435.716.1000
Lam W. Thanadabout, MD	500 East 1400 North, Logan, UT 84341	435.716.1000

INTERNAL MEDICINE

David S. Faux, MD	1350 North 500 East, Logan, UT 84341	435.792.1806
Michael R. Francis, DO	1350 North 500 East, Logan, UT 84341	435.792.1780
Russell N. Hirst, MD	1565 South 800 East, Lewiston, UT 84320	435.258.2441
Jeffrey M. Huffman, MD	1350 North 500 East, Logan, UT 84341	435.792.1810
Robert M. Nash, MD	1350 North 500 East, Logan, UT 84341	435.792.1805
Steven S. Salisbury, MD	1300 North 500 East, Suite 370, Logan, UT 84341	435.755-2100
Michael J. Stones, MD	1350 North 500 East, Logan, UT 84341	435.792.1807
Jeffrey S. Strong, MD	1350 North 500 East, Logan, UT 84341	435.792.1808
Agnes M. Szpunar, MD	1350 North 500 East, Logan, UT 84341	435.792.1804

NEUROLOGY

Hal G. Astle, MD	2380 North 400 East, Suite A, North Logan, UT 84341	435.713.1300
Michael H. Williams, MD	1350 North 500 East, Logan, UT 84341	435.792.1809

OBSTETRICS & GYNECOLOGY

James P. Benedict, MD	500 East 1400 North, Logan, UT 84341	435.716.1920
Anne S. Blackett, DO	1325 North 600 East, Suite 102, Logan, UT 84341	435.753.9999
Kristin F. Craig, MD	500 East 1400 North, Logan, UT 84341	435.716.1920
Gary K. Fowers, MD	1325 North 600 East, Suite 102, Logan, UT 84341	435.753.9999
E. Brett Horsley, DO	500 East 1400 North, Logan, UT 84341	435.716.1920
David A. Kirkman, MD	1325 North 600 East, Suite 102, Logan, UT 84341	435.753.9999
Kimberly D. McCulloch, MD	500 East 1400 North, Logan, UT 84341	435.716.1920
Barry A. Noorda, MD	1325 North 600 East, Suite 102, Logan, UT 84341	435.753.9999
Tandy G. Olsen, MD	500 East 1400 North, Logan, UT 84341	435.716.1920
Robert P. Strebhel, MD	550 East 1400 North, Suite I, Logan, UT 84341	435.753.1545
Danee S. Young, MD (GYN)	920 North 200 West, Suite A, Logan, UT 84321	435.750.0366

NURSE PRACTITIONERS/PHYSICIAN ASSISTANTS: (Those marked * are OB/Gyn providers, not on hospital medical staff)

Jennifer Anderson, NP*	500 East 1400 North, Logan, UT 84341	435.716.1920
Amy A. Billings, PA*	1325 North 600 East, Suite 102, Logan, UT 84341	435.753.9999
Jamie P. Larson, PA*	1325 North 600 East, Suite 102, Logan, UT 84341	435.753.9999
Ena Murillo, PA*	500 East 1400 North, Logan, UT 84341	435.716.1920
Angie Thompson, NP*	500 East 1400 North, Logan, UT 84341	435.716.1920
Kenneth A. Wade, PA	1325 North 600 East, Suite 102, Logan, UT 84321	435.753.9999

CERTIFIED NURSE MIDWIVES:

Deborah Flansburg, CNM	500 East 1400 North, Logan, UT 84341	435.716.1920
D'Anne Moon, CNM	1325 North 600 East, Suite 102, Logan, UT 84341	435.753.9999
Karina Robbins, CNM	550 East 1400 North, Suite I, Logan, UT 84341	435.753.1545

OCCUPATIONAL MEDICINE

T. Michael Bishop, MD	412 North 200 East (WorkMed), Logan, UT 84321	435.713.2850
Michael C. Housley, MD	412 North 200 East (WorkMed), Logan, UT 84321	435.713.2850

ADDITIONAL PHYSICIAN AT THIS LOCATION, NOT ON THE LOGAN REGIONAL HOSPITAL MEDICAL STAFF:

Kim Heaton, MD	412 North 200 East (WorkMed), Logan, UT 84321	435.713.2850
----------------	---	--------------

ONCOLOGY

Ali Ben-Jacob, MD 1281 North 600 East, Logan, UT 84341 435.752.5999

OPHTHALMOLOGY

Jonathan A. Feistmann, MD 120 West Cache Valley Blvd., Suite 100, Logan, UT 84341 435.713.2222
 Matthew D. Hammond, MD 120 West Cache Valley Blvd., Suite 100, Logan, UT 84341 435.787.7200
 Christian D. Nilson, MD 550 East 1400 North, Suite T, Logan, UT 84341 435.752.2020
 J. Scott Raymond, MD 550 East 1400 North, Suite P, Logan, UT 84341 435.753.4541
 Jon A. Siler, MD 1300 North 500 East, Suite 350, Logan, UT 84341 435.752.7445
 David G. Waterman, MD 1300 North 500 East, Suite 350, Logan, UT 84341 435.752.7445
 Steven R. Young, MD 1300 North 500 East, Suite 220, Logan, UT 84341 435.753.5220

ORAL SURGERY

Gregory E. Anderson, DDS 1395 North 400 East, Logan, UT 84341 435.755.5000
 Stuart D. Wilkinson, DDS 1320 North 600 East, Suite 3, Logan, UT 84341 435.752.5681
 Michael Wilkinson, DDS 1320 North 600 East, Suite 3, Logan, UT 84341 435.752.5681

ORTHOPEDIC SURGERY

Brent A. Felix, MD 2310 North 400 East, Suite A, North Logan, UT 84341 435.787.2000
 Terry I. Finlayson, MD 2310 North 400 East, North, Suite A, Logan, UT 84341 435.787.2000
 E. Marlowe Goble, MD 2380 North 400 East, Suite G, North Logan, UT 84341 435.787.8467
 Gregory J. Hicken, MD 2310 North 400 East, Suite A, North Logan, UT 84341 435.787.2000
 Thomas O. Higginbotham, MD 1300 North 500 East, Suite 130, Logan, UT 84341 435.716.2800
 Eric W. Hooley, MD 1300 North 500 East, Suite 130, Logan, UT 84341 435.716.2800
 Brad J. Larson, MD 2310 North 400 East, Suite A, North Logan, UT 84341 435.787.2000
 Bryan C. King, MD 1300 North 500 East, Suite 130, Logan, UT 84341 435.716.2800
 Brent W. Miller, MD 2310 North 400 East, Suite A, North Logan, UT 84341 435.787.2000
 David P. Murray, MD 1300 North 500 East, Suite 130, Logan, UT 84341 435.716.2800
 Keith J. Nelson, MD 2310 North 400 East, Suite A, Logan, UT 84341 435.787.2000

PHYSICIAN ASSISTANTS/NURSE PRACTITIONER:

Douglas Casperson, PA 2310 North 400 East, Suite A, North Logan, UT 84341 435.787.2000
 Randy Chadwell, PA 2310 North 400 East, Suite A, North Logan, UT 84341 435.787.2000
 Lance DeLange, APRN 2310 North 400 East, Suite A, North Logan, UT 84341 435.787.2000
 Scott Hunt, PA 1300 North 500 East, Suite 130, Logan, UT 84341 435.716.2800
 Julie Patterson, PA 1300 North 500 East, Suite 130, Logan, UT 84341 435.716.2800
 Shaun Peterson, PA 2310 North 400 East, Suite A, North Logan, UT 84341 435.787.2000
 Benjamin Stowers, PA 1300 North 500 East, Suite 130, Logan, UT 84341 435.716.2800
 Whitney Werner, PA 2310 North 400 East, Suite A, North Logan, UT 84341 435.787.2000

OTOLARYNGOLOGY

Jeffrey G. Bennion, MD 2380 North 400 East, Suite D, North Logan, UT 84341 435.753.7880
 James W. Blotter, MD 2380 North 400 East, Suite D, North Logan, UT 84341 435.753.7880
 Jeffrey S. Keyser, MD 1350 North 500 East, Logan, UT 84341 435.792.1950
 Gordon S. Wood, MD 2380 North 400 East, Suite D, North Logan, UT 84341 435.753.7880/
NURSE PRACTITIONER:
 Kathleen M. Stahl, APRN 1350 North 500 East, Logan, UT 84341 435.792.1950

PAIN MANAGEMENT

Vikas Garg, MD 2380 North 400 East, Suite A, North Logan, UT 84341 435.713.9681

PATHOLOGY

Matthew M. Kershisnik, MD 500 East 1400 North, Logan, UT 84341 435.716.5401
 Jonathan F. Koehler, MD 500 East 1400 North, Logan, UT 84341 435.716.5401

PEDIATRICS

Craig W. Armstrong, MD 2380 North 400 East, Suite C, North Logan, UT 84341 435.753.7337
 Ryan R. Bell, MD 1325 North 600 East, Suite 101, Logan, UT 84341 435.750.5599
 Nordell T. Brown, MD 1350 North 500 East, Logan, UT 84341 435.792.1940
 Derrel W. Clarke, MD 1350 North 500 East, Logan, UT 84341 435.792.1940
 Prafulla D. Garg, MD 1350 North 500 East, Logan, UT 84341 435.792.1940
 Tyson S. Horkley, MD 1350 North 500 East, Logan, UT 84341 435.792.1940
 Nina G. Jorgensen, MD 2380 North 400 East, Suite C, North Logan, UT 84341 435.753.7337
 Barrett P. Labrum, DO 2380 North 400 East, Suite C, North Logan, UT 84341 435.753.7337
 Russell T. McKenna, DO 1325 North 600 East, Suite 101, Logan, UT 84341 435.750.5599
 J. Dennis Odell, MD 1350 North 500 East, Logan, UT 84341 435.792.1940
 Bruce A. O'Very, MD 1325 North 600 East, Suite 101, Logan, UT 84341 435.750.5599
 Stephen D. Schneider, MD 1350 North 500 East, Logan, UT 84341 435.792.1940
 Michael K. Visick, MD 1350 North 500 East, Logan, UT 84341 435.792.1940
NURSE PRACTITIONER:

PHYSICAL MEDICINE

Michael L. Clegg, MD	2310 North 400 East, Suite A, North Logan, UT 84341	435.787.2000
Jacob R. Egbert, DO	190 South Hwy 165, Providence, UT 84332	435.755.3355
Cameron G. Peterson, MD	1350 North 500 East, Suite 120, Logan, UT 84341	435.716.2800
Jacob B. Pugsley, DO	2310 North 400 East, Suite A, North Logan, UT 84341	435.787.2000

PLASTIC SURGERY

Blaine P. Andersen, MD	1300 North 500 East, Suite 260, Logan, UT 84341	435.753.3400
Casey N. Isom, MD	1350 North 500 East, Suite 310, Logan, UT 84341	435.787.1108

PODIATRY

David D. Bell, DPM	1219 North 400 East, Logan, UT 84341	435.753.7000
Gregory B. Cook, DPM	550 East 1400 North, Suite B, Logan, UT 84341	435.752.9011
W. Bryce Cook, DPM	550 East 1400 North, Suite B, Logan, UT 84341	435.752.9011
David G. Edwards, DPM	2310 North 400 East, Suite A, North Logan, UT 84341	435.787.2000
Spencer B. Heninger, DPM	2310 North 400 East, Suite A, North Logan, UT 84341	435.787.2000
Daniel J. Huff, DPM	272 North Spring Creek Parkway, Providence, UT 84332	435.787.1023
Curtis C. Pedersen, DPM	1300 North 500 East, Suite 130, Logan, UT 84341	435.716.2840
Brian R. Richman, DPM	550 East 1400 North, Suite N, Logan, UT 84341	435.752.1038

PSYCHIATRY

Jeffrey McCann, MD	1300 North 500 East, Suite 250, Logan, UT 84341	435.716.5790
Brian L. Merrill, DO	1300 North 500 East, Suite 250, Logan, UT 84341	435.716.5790

RADIOLOGY

Mark D. Anderson, MD	500 East 1400 North, Logan, UT 84341	435.716.5242
John W. Bitwinski, MD	500 East 1400 North, Logan, UT 84341	435.716.5242
C. Richard Hopkins, MD	500 East 1400 North, Logan, UT 84341	435.716.5242
Jeffrey S. Job, MD	500 East 1400 North, Logan, UT 84341	435.716.5242
Blake C. Mortnenson, MD	500 East 1400 North, Logan, UT 84341	435.716.5242
Daniel J. Parker, MD	500 East 1400 North, Logan, UT 84341	435.716.5242

RHEUMATOLOGY

Corey W. Walker, MD	1350 North 500 East, Logan, UT 84341	435.792.1518
---------------------------	--	--------------

SPORTS MEDICINE

Trek D. Lyons, MD	1300 North 500 East, Suite 130, Logan, UT 84341	435.716.2800
-------------------------	---	--------------

URGENT CARE

David N. Casey, DO	412 North 200 East (InstaCare), Logan, UT 84321	435.713.2710
Douglas N. Esplin, MD	412 North 200 East (InstaCare), Logan, UT 84321	435.713.2710
ADDITIONAL PHYSICIANS AT THIS LOCATION, NOT ON THE LOGAN REGIONAL HOSPITAL MEDICAL STAFF:		
Kurt King, MD	412 North 200 East (InstaCare), Logan, UT 84321	435.713.2710
April Larkin, MD	412 North 200 East (InstaCare), Logan, UT 84321	435.713.2710
Rebecca Phillips, MD	412 North 200 East (InstaCare), Logan, UT 84321	435.713.2710

UROLOGY

Michael S. Callister, MD	1350 North 500 East, Logan, UT 84341	435.792.1950
Ryan H. Larsen, MD	550 East 1400 North, Suite J, Logan, UT 84341	435.753.1171
PHYSICIAN ASSISTANTS:		
Teryl Hunsaker, PA	1350 North 500 East, Logan, UT 84341	435.792.1950
Brent Pitcher, PA	1350 North 500 East, Logan, UT 84341	435.792.1950

LOGAN REGIONAL HOSPITAL CAMPUS MAP

Level 3

Budge Administration
Cache Valley Heart Clinic
Cache Valley Eye Associates
Dialysis
Extended Care, Rms. 316-326
GI Lab
ICU, Rms. 363-364, 366-376
Internal Medicine (Budge)
Isom, Casey, M.D.
Logan Optical
Medical, Rms. 351-362, 377-391
Mother/Baby
Nursery
Pediatrics, Rms. 304-312
Salisbury, Steven, M.D.
Surgical Care, Rms. 301-303, 327-338

Level 2

Anderson, Blaine, M.D.
Behavioral Health
Business Office
Cardiac Rehab
Cath Lab
Classrooms 5-6
Dermatology (Budge)
Ear, Nose, & Throat (Budge)
EEG
Emergency
General Surgery (Budge)
Hearing Clinic (Budge)
Heart Services (Cardiology)
Infusion
Labor & Delivery
Laboratory
Medical Records
Merrill, Brian, D.O.
Newborn Intensive Care
Operating Rooms
Radiology/Imaging
Respiratory
Sleep Disorders Center
Speech & Hearing
Spine Institute / Physical Rehabilitation
Surgical Center
Urology (Budge)
Voice Clinic (Budge)
X-ray/Imaging
Young, Steven, M.D.

Level 1

Administration
Cafeteria
Canyon View Orthopedics
Classrooms 1-4, 7-8
Education
Gift Shop
Human Resources
Laboratory (Budge)
Lactation
Mammography
Obstetrics & Gynecology (Budge)
Pediatrics (Budge)
Pharmacy
Physical Therapy
Podiatry
Volunteer Office
X-ray (Budge)

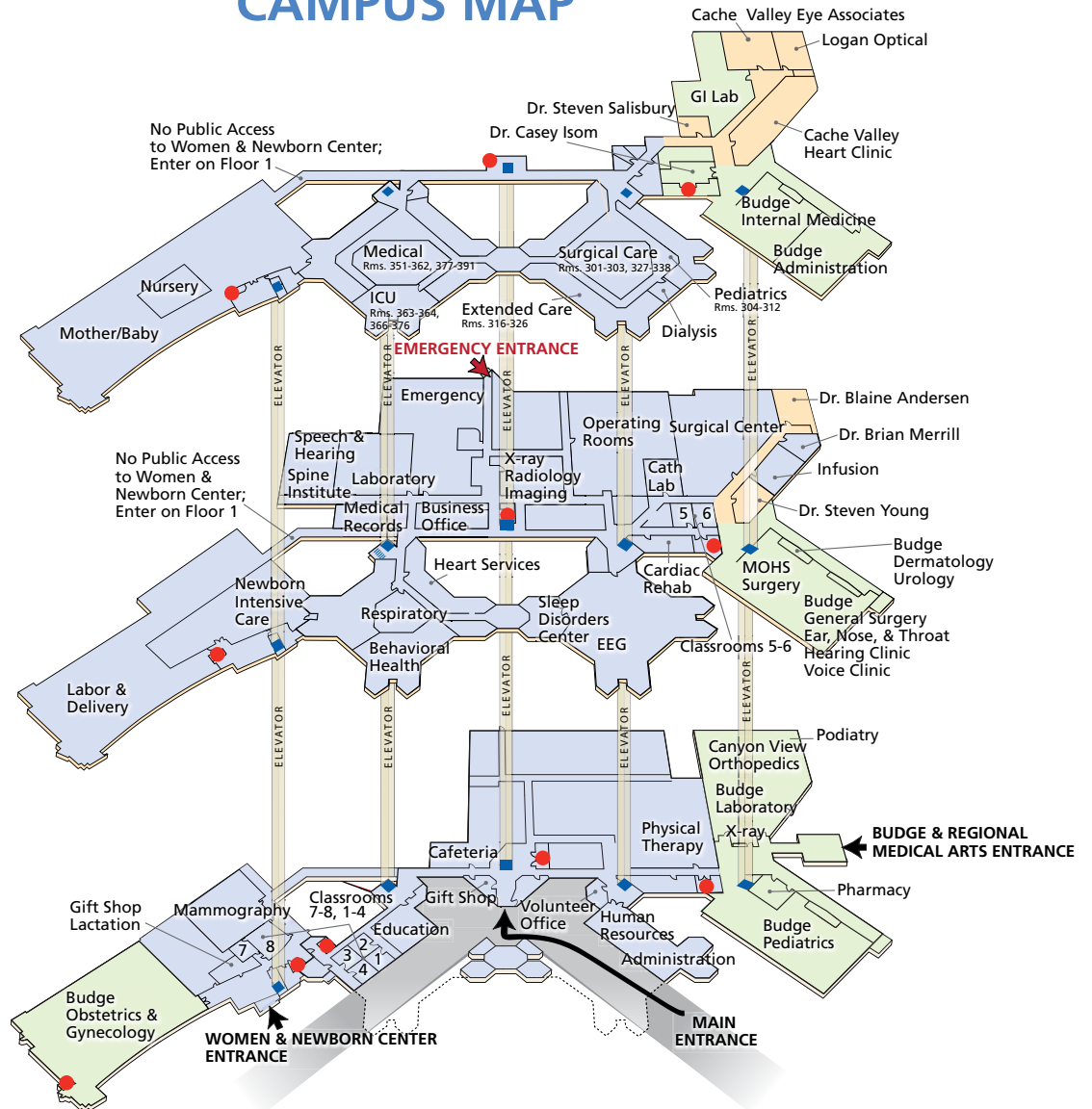

KEY

- Restroom
- Elevator
- Hospital
- Budge Clinic
- Regional Medical Arts
- BUS Bus Stop